

TITLE	CORAL, 143 CROCKHAMWELL ROAD, WOODLEY, READING. RG5 3JP APPLICATION FOR A PREMISES LICENCE UNDER THE GAMBLING ACT 2005
FOR CONSIDERATION BY	Sub Committee of the Licensing and Appeals Committee on 19 November 2014
WARD	Bulmershe and Whitegates
STRATEGIC DIRECTOR	Paul Anstey, Joint Service Delivery Manager for Environmental Health & Licensing

OUTCOME / BENEFITS TO THE COMMUNITY
--

In accordance with S163 of the Gambling Act 2005 and the Wokingham Borough Council Statement of Principles Licensing Policy, the application is referred to the Licensing and Appeals Sub Committee for determination as representations have been received.
--

RECOMMENDATION

The Sub Committee to determine the application to grant or refuse the application, with conditions and/or amendments as appropriate.
--

SUMMARY OF REPORT

To provide relevant information for the Sub Committee to consider and determine the application by Coral Racing Ltd for a new Betting (other) premises licence at 143 Crockhamwell Road, Woodley, Reading, RG5 3JP.

Background

The application for a new Betting (other) premises licence under the Gambling Act 2005 was received on 11 September 2014.

The following documentation is attached – copy of the application (Appendix One), location / layout plans (Appendix Two), representations (Appendix Three)

The application was checked and confirmed to be correctly made before starting the 28 day consultation period, this ran until 9 October 2014. The applicant confirmed in writing that there was also enclosed with the application, a copy of the notice to be displayed on the premises and advertised in a local newspaper and a copy of the notice of application had been sent to the relevant Responsible Authorities. The responsible authorities, ward members and parish council were advised by email on 12 September 2014.

Details of the application are as follows:

- Applicant: Coral Racing Ltd, Glebe House, Vicarage Drive, Barking, Essex, IG11 7NS
- Times of operation: no request to exclude the default condition regarding times of operation (default hours Sunday to Saturday from 0700 to 2200)

The application has been advertised with a notice placed in the Reading Chronicle on 11 September 2014. The site notice was checked and found to be present on 7 October 2014.

During the statutory consultation period of 28 days, representations were received from Cowan Bookmakers, Linda Matthews on behalf of Woodley Town Council, Cll Mary Holmes on behalf of Woodley Town Centre Management Initiative, Jacques Lherbier, Town Centre Manager, Greg Bello, Ian Hills and Nick Jackson.

Responses Received from Responsible Authorities

Thames Valley Police – no objections

Fire Authority – no representation

Environmental Health – no objections

Gambling Commission – no response

H M Revenue and Customs – no response

Planning – no objection

Children and Young People's Services – no response

Representations from Interested Parties

Representations were received from:

- Cowan, The Bookmaker Limited (3a)
- Linda Matthews, Committee Officer, Woodley Town Council (3b)
- Cll Mary Holmes, Chairman of Woodley Town Centre Management Initiative (3c)
- Jacques Lherbier, Town Centre Manager, Woodley (3d)
- Greg Bello, 79 Vauxhall Drive, Woodley (3e)
- Ian Hills, 3 Halstead Close, Woodley (3f)
- Nick Jackson, Southlake St James, Woodley (3g)

Representations from Interested Parties received out of the consultation period

- A Brown, 44 Hazel Drive, Woodley (3h)
- J Joelyer, 34 Wydham Crescent, Woodley (3i)

These are included as Appendix Three together with the responses sought from

interested parties who were asked for clarification of who they represented

Analysis of Issues

Promotion of the three licensing objectives:

- Preventing gambling from being a source of crime or disorder, being associated with crime or disorder or being used to support crime
- Ensuring that gambling is conducted in a fair and open way
- Protecting children and other vulnerable persons from being harmed or exploited by gambling

Requirement of Gambling Act 2005 to determine an application and have regard to the three licensing objectives – prevention of crime and disorder, public safety, prevention of public nuisance and protection of children from harm.

FINANCIAL IMPLICATIONS OF THE RECOMMENDATION

	How much will it Cost/ (Save)	Is there sufficient funding – if not quantify the Shortfall	Revenue or Capital?
Current Financial Year (Year 1)	Not applicable		
Next Financial Year (Year 2)	Not applicable		
Following Financial Year (Year 3)	Not applicable		

Other financial information relevant to the Recommendation/Decision

None

Cross-Council Implications (how does this decision impact on other Council services and priorities?)

Not applicable

Reasons for considering the report in Part 2

None

List of Background Papers

Gambling Act 2005 Statement of Principles
 Relevant guidance issued by the Gambling Commission
 Application forms, location plans, representations

Contact	Julia O'Brien	Service	Licensing Service
Telephone No	01635 519791	Email	jobrien@westberks.gov.uk
Date	29 October 2014	Version No.	1

Application for a premises licence under the Gambling Act 2005

PLEASE READ THE FOLLOWING INSTRUCTIONS FIRST

If you are completing this form by hand, please write legibly in block capitals using ink. Use additional sheets if necessary (marked with the number of the relevant question). You may wish to keep a copy of the completed form for your records.

Where the application is—

- In respect of a vessel, or
 - To convert an authorisation granted under the Betting, Gaming and Lotteries Act 1963 or the Gaming Act 1968,
- the application should be made on the relevant form for that type of premises or application.

Part 1 – Type of premises licence applied for

- Regional Casino Large Casino Small Casino
 Bingo Adult Gaming Centre Family Entertainment Centre
 Betting (Track) Betting (Other)

Do you hold a provisional statement in respect of the premises? Yes No

If the answer is "yes", please give the unique reference number for the provisional statement (as set out at the top of the first page of the statement):

Part 2 – Applicant Details

If you are an individual, please fill in Section A. If the application is being made on behalf of an organisation (such as a company or partnership), please fill in Section B.
Section A

Individual applicant

1. Title: Mr Mrs Miss Ms Dr Other (please specify)

2. Surname: _____ Other name(s): _____
[Use the names given in the applicant's operating licence or, if the applicant does not hold an operating licence, as given in any application for an operating licence]

3. Applicant's address (home or business – *[delete as appropriate]*):
 Postcode: _____

4(a) The number of the applicant's operating licence (as set out in the operating licence):

4(b) If the applicant does not hold an operating licence but is in the process of applying for one, give the date on which the application was made:

5. Tick the box if the application is being made by more than one person.
[Where there are further applicants, the information required in questions 1 to 4 should be included on additional sheets attached to this form, and those sheets should be clearly marked "Details of further applicants".]

Section B**Application on behalf of an organisation**

6. Name of applicant business or organisation: **Coral Racing Ltd**
[Use the names given in the applicant's operating licence or, if the applicant does not hold an operating licence, as given in any application for an operating licence.]

7. The applicant's registered or principal address:

**Glebe House
Vicarage Drive
Barking
Essex**

Postcode: **IG11 7NS**

8(a) The number of the applicant's operating licence (as given in the operating licence): **001- 002360 - N - 102405 - 001**

8(b) If the applicant does not hold an operating licence but is in the process of applying for one, give the date on which the application was made:

9. Tick the box if the application is being made by more than one organisation.

[Where there are further applicants, the information required in questions 6 to 8 should be included on additional sheets attached to this form, and those sheets should be clearly marked "Details of further applicants".]

Part 3 – Premises Details

10. Proposed trading name to be used at the premises (if known): **Coral**

11. Address of the premises (or, if none, give a description of the premises and their location):

**143 Crockhamwell Road
Woodley
Reading**

Postcode: **RG5 3JP**

12. Telephone number at premises (if known): **Not yet known**

13. If the premises are in only a part of a building, please describe the nature of the building (for example, a shopping centre or office block). The description should include the number of floors within the building and the floor(s) on which the premises are located.

Mid terrace ground floor lock-up shop with two storeys of separately accessed residence above

14(a) Are the premises situated in more than one licensing authority area? **No**

14(b). If the answer to question 14(a) is yes, please give the names of all the licensing authorities within whose area the premises are partly located, **other than the licensing authority to which this application is made:**

Part 4 – Times of operation

15(a). Do you want the licensing authority to exclude a default condition so that the premises may be used for longer periods than would otherwise be the case? **No** [delete as appropriate] [Where the relevant kind of premises licence is not subject to any default conditions, the answer to this question will be no.]

15(b). If the answer to question 15(a) is yes, please complete the table below to indicate the times when you want the premises to be available for use under the premises licence.

	Start	Finish	Details of any seasonal variation
Mon	hh:mm	hh:mm	
Tue			
Wed			
Thurs			
Fri			
Sat			
Sun			

16. If you wish to apply for a premises licence with a condition restricting gambling to specific periods in a year, please state the periods below using calendar dates:

Part 5 – Miscellaneous

17. Proposed commencement date for licence (leave blank if you want the licence to commence as soon as it is issued):

18(a). Does the application relate to premises which are part of a track or other sporting venue which already has a premises licence? **No**

18(b). If the answer to question 18(a) is yes, please confirm by ticking the box that an application to vary the main track premises licence has been submitted with this application.

19(a). Do you hold any other premises licences that have been issued by this licensing authority?

Yes

19(b). If the answer to question 19(a) is yes, please provide full details:

**244 High Street Crowthorne Berkshire RG45 7AP
6 The Parade Silverdale Road Earley Reading Berks RG6 7NZ
15 London Road Twyford Berkshire RG10 9EH**

20. Please set out any other matters which you consider to be relevant to your application:

Part 6 – Declarations and Checklist (Please tick)	
I confirm that, to the best of my knowledge, the information contained in this application is true. I understand that it is an offence under section 342 of the Gambling Act 2005 to give information which is false or misleading in, or in relation to, this application.	✓
I confirm that the applicant(s) have the right to occupy the premises.	✓
Checklist:	
• Payment of the appropriate fee has been is enclosed	✓
• A plan of the premises is enclosed	✓
• I understand that if the above requirements are not complied with the application may be rejected	✓
• I understand that it is now necessary to advertise the application and give the appropriate notice to the responsible authorities	✓

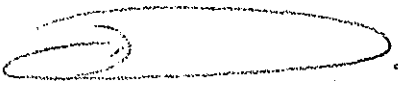
Part 7 – Signatures	
21. Signature of applicant or applicant's solicitor or other duly authorised agent. If signing on behalf of the applicant, please state in what capacity: Signature:	
	
Print name: Dave Willis	Capacity: Development Manager
Date: 10th September 2014	
22. For joint applications, signature of 2nd applicant, or 2nd applicant's solicitor or other authorised agent. If signing on behalf of the applicant, please state in what capacity: Signature:	
Print name:	Capacity:
Date: (dd/mm/yyyy)	
<i>Where there are more than two applicants, please use an additional sheet clearly marked "Signature(s) of further applicant(s)". The sheet should include all the information requested in paragraphs 21 and 22.]</i>	
<i>[Where the application is to be submitted in an electronic form, the signature should be generated electronically and should be a copy of the person's written signature.]</i>	

Part 8 – Contact Details

23(a) Please give the name of a person who can be contacted about the application:

Dave Willis

23(b) Please give one or more telephone numbers at which the person identified in question 23(a) can be contacted:

Office: 01252 350180

Mobile: 07714 063553

24. Postal address for correspondence associated with this application:

**Dave Willis
Coral Estates
46 Station Road
Aldershot
Hampshire**

Postcode: **GU11 1HT**

25. If you are happy for correspondence in relation to your application to be sent via e-mail, please give the e-mail address to which you would like correspondence to be sent:

dave.willis@coral.co.uk

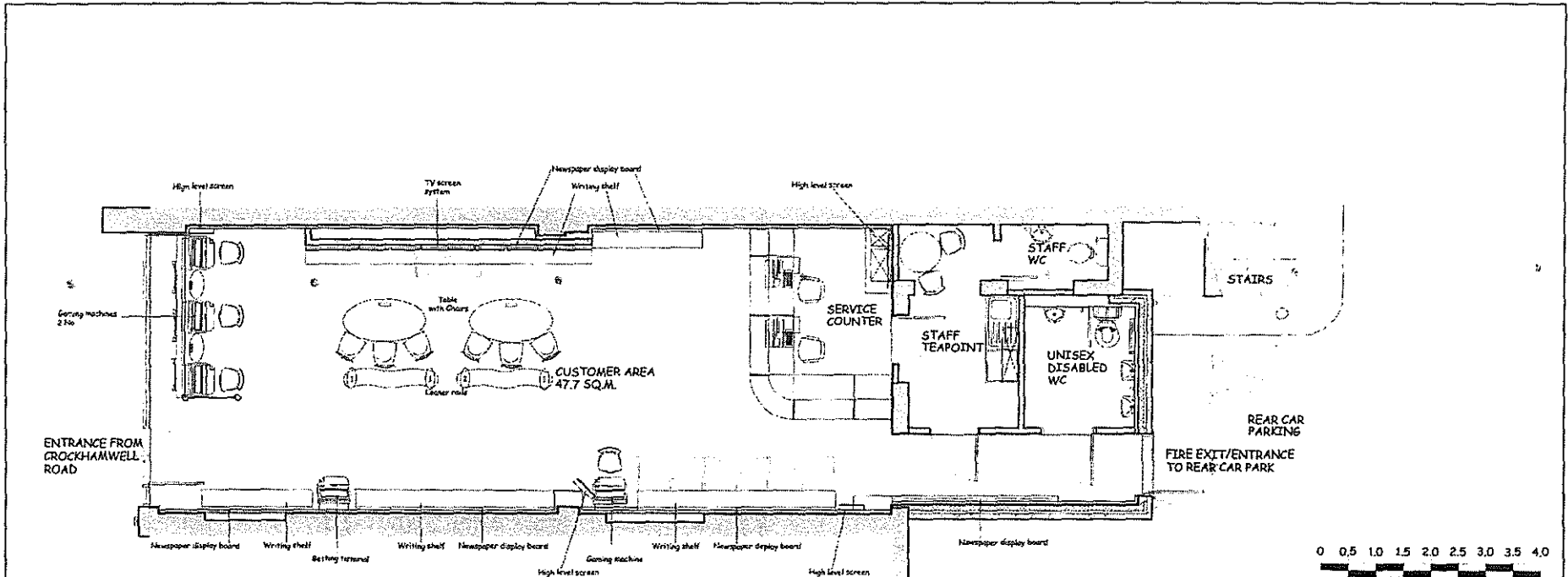

GROUND FLOOR PLAN (1:50)

Induction Loop Sign

An induction loop is provided for the benefit of hearing aid users to use switch hearing aid to 'T'

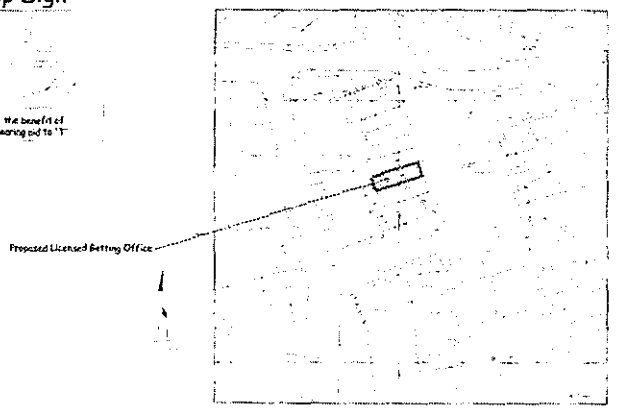

SITE LOCATION PLAN (Scale 1:1250)

Ordnance Survey, Crown Copyright © 2008.
All Rights Reserved License No. 100035607

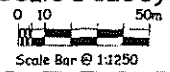

KEY

The location and extent of that part of the premises which will be used to provide facilities for gambling in reliance of the licence

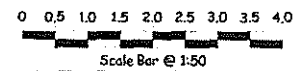

CORAL

GENERAL NOTES
DO NOT SCALE FROM THIS DRAWING. ALL DIMENSIONS TO BE CHECKED ON SITE.

Rev: Amendment Date:

Company Name & Address:
CORAL
One Stratford Place,
Manchester Road,
London
E20 1EJ

Project Name & Address:
Proposed Licensed Betting Office at
143 Crookhamwell Road,
Woodley,
Reading, RG5 3JP

Drawn by: RRDS
Date: 5 September 2014
Scale: 1:50 @ A2
Drawing No: COR1739/LP1

www.blandy.co.uk



BLANDY & BLANDY

Excellence | Integrity | Approachability

From: Licensing [<mailto:licensing@wokingham.gov.uk>]

Sent: 09 October 2014 09:52

To: Sue Dowling

Subject: RE: Representation/objection against Betting Office Premises Licence application for 143 Crockhamwell Road

Dear Ms Dowling,

We are in receipt of your Representation in respect of the application for 143 Crockhamwell Road.

Kind Regards

Madeline Ally

Assistant Technical Officer

Environmental Health and Licensing Service | West Berkshire and Wokingham | Civic Offices, Shute End, Wokingham, RG40 1BN

(01635) 519 176 / 0118 974 6000 (ext 6359) | Fax (0118) 900 7479 |

From: Sue Dowling [<mailto:Sue.Dowling@Blandy.co.uk>]

Sent: 08 October 2014 16:27

To: Licensing

Subject: Representation/objection against Betting Office Premises Licence application for 143 Crockhamwell Road

Importance: High

** This message is subject to the confidentiality notice at the end of this communication **

Dear Sirs

Application by Corals for a Betting Office Premises Licence at 143 Crockhamwell Road, Woodley, Reading

Objections required by 9 October 2014

We have been instructed by Cowan The Bookmaker Limited (by its director, Mr Lewis Cowan) to oppose the above application for a Betting Office Licence, recently lodged by Coral Racing Ltd. Our client is an

“Interested Party” to this application pursuant to section 158(b) Gambling Act 2005 (GA), as its betting office is a few doors down from the proposed premises, at 151 Crockhamwell Road. By way of additional information, there is another betting office (operated by William Hill) in the same shopping precinct at 116 Crockhamwell Road.

Our client has instructed us to lodge a representation on its behalf (pursuant to section 161 of Gambling Act 2005), to oppose the application on the basis that the Licensing Objectives under section 1 of the Gambling Act 2005 will be negatively impacted, if the application is granted. In particular, our client will argue that, in all likelihood, there will be an increase in crime and a negative effect on the protection of children (including young adults) and other vulnerable persons, in the event that another betting office (also offering the controversial Fixed Odds betting terminals) is permitted to open in the close confines of the shopping precinct, in Crockhamwell Road. In view of the mixed demographic of shoppers that visit this shopping precinct (from the nearby large residential area and from further afield) including young people, it is inevitable that gambling activities will be given a much higher profile and increased exposure to children and young adults, if a third additional Betting Office is permitted to open.

To clarify, our client’s representation is not on the basis that there is a lack of demand for an additional betting office as it fully appreciates that this is not a valid form of objection under the GA 2005. We also confirm that, if notwithstanding our client’s (or any other objections) this application is eventually granted, our client’s shop will continue to trade – resulting in 3 betting offices within yards of each other. We wish to emphasise that our client’s objection is on the basis that a 3rd betting office, in such a confined location, will inevitably lead to rising problems in crime, disorder, underage gambling and/or problem gambling, and that such a proliferation of betting office facilities should not be authorised, being contrary to the maintenance and promotion of the Licensing Objectives and to the Gambling Commission’s Guidance (again relating to those Licensing Objectives). In relation to the Guidance, our client will make reference to the full terms of it (as appropriate) including (but not limited to) paragraph 7.54. It is implicit from the latter paragraph that where there will be too many gambling premises in the locality, pointing to rising problems in crime, disorder, underage gambling or problem gambling, this will amount to a relevant representation under the Act.

In support of its objection/representation, our client also considers that the views expressed in the attached Gambling Protections and Controls DCMS paper are of relevance and reference to the same may be made at any Licensing Committee Hearing relating to this matter. Our understanding is that 143 Crockhamwell Road was formerly an estate agency so would fall squarely within the recommendations, in terms of extra planning requirements, mentioned in the attached document.

Finally there would be a further negative consequence in the event that the proposed application was granted relating to the increased likelihood of trespass. Our client owns the car park area that runs behind his shop and extends beyond the proposed premises. If the proposed application was granted, there is a strong likelihood that those visiting the betting facilities at 143, by car, would park on our client’s land, committing trespass (as they would be parking there without his consent). This could result in possible disorder and disruption when those individuals are required to remove their vehicles from the area concerned.

Accordingly, kindly confirm that this representation concerning the probable negative implications referred to above, which would have a detrimental impact on the promotion of the Licensing Objectives (under section 1(a) and 1(c) of the GA 2005), is accepted and we look forward to hearing from you further concerning when this matter will be listed before the Committee for Hearing.

Kindly confirm safe receipt of this representation; a short acknowledgement to the writer, Sue Dowling, will suffice.

Yours faithfully



Department
for Culture
Media & Sport

Gambling Protections and Controls

April 2014

Following a process of policy review, I am adopting a precautionary approach with targeted and proportionate action to protect players further when using high stake gaming machines on the high street. The measures set out in this document are intended to help customers stay in control. In line with the Government's Principles of Regulation, any new statutory regulations will be subject to an Impact Assessment which will assess the net cost to business and will be subject to independent scrutiny by the Regulatory Policy Committee. I expect changes to take effect from October 2014.



Helen Grant MP
Minister for Sport, Tourism and Equalities

Player Protection Measures

Gambling operators are already required to maintain certain standards of social responsibility. The Gambling Commission's Licence Conditions and Codes of Practice set out a number of social responsibility conditions which operators must comply with or face licence suspension, revocation or the imposition of a financial penalty.

However, it is clear that some people have encountered considerable problems with their gambling despite the obligations on operators to supervise their customers. A combination of high stakes and natural game volatility (where the player might be encouraged by the odd small win to put at risk high stakes) can generate significant losses in a short space of time⁵. We want players who use gaming machines to be in control of the choices they make. This is particularly important for users of category B2 gaming machines, where it is possible for individuals to place higher stakes.

For these reasons, the Government is adopting a precautionary approach to high stake gaming machines on the high street. Our measures are justified on a proportionate, targeted basis to help people remain in control of their gambling. At the heart of our approach are measures designed to give players better information, and to provide break points and pauses for thought to help people stay in control.

The Government intends to:

- **Require those accessing higher stakes (over £50) to use account-based play or load cash over the counter.** Requiring better interaction between customer and operator for those engaged in high stake play improves opportunities for more effective provision of information and interventions.

To support this measure Government wants:

- **All larger betting shop operators to offer account based play.** This will allow account holders to track and monitor their own play via statements, and enable targeted interventions in accordance with operators' licence conditions.

There are significant advantages to this approach. Account based play allows players access to up-to-date and accurate information which can reduce biased or irrational gambling-related decisions and help people maintain control⁶. The Government considers account summaries or activity statements may be a particularly effective way of giving clear

⁵ Gambling Commission formal advice to the Secretary of State for Culture, Media & Sport, 2013

⁶ Cashless and card-based technologies in gambling: A review of the literature, Gambling Commission, 2008

Gambling Advertising

The codes which govern gambling advertising are now applied across a much changed gambling landscape with the availability and promotion of new products which were not anticipated when the codes were devised. It is timely that the codes are re-examined to ensure that existing controls keep pace with developments in the market, provide adequate protection – especially to children and the vulnerable – and remain consistent with public expectations about gambling advertising.

There is some evidence that gambling advertising may maintain or exacerbate already existing gambling problems.⁹ The Government wants the industry and its regulators to carefully reconsider whether the tone, content and volume of gambling adverts is appropriate for general audiences and meets societal expectations, especially where adverts offer financial inducements or encourage 'in play' and other instantly accessible online gambling.

The Government has initiated the following work:

- The Remote Gambling Association will make recommendations to Government on any changes needed to the industry voluntary code, including on the suitability of the **9pm watershed arrangements**.
- The Committee of Advertising Practice and the Broadcast Committee of Advertising Practice will evaluate the latest evidence in relation to gambling advertising and problem gambling to consider **what regulatory implications** arise as a result.
- The Advertising Standards Authority will report on the proportionality, robustness and consistency of its **enforcement action** on the gambling rules.
- The Gambling Commission will ensure that its current review of licence conditions and codes of practice (which includes a focus **on free bets and bonuses**) ensures that all gambling advertising continues to comply with the licensing objectives of the Gambling Act 2005.

This work will be complete by the end of 2014. The Government retains powers under the Gambling Act 2005 to make regulations about gambling advertising.

⁹ Gambling Advertising: A Critical Research Review, Report Prepared by Per Binde for the Responsible Gambling Trust, 2014

APPENDIX
3b

Madeline Ally

From: Linda Matthews <linda.matthews@woodley.gov.uk>
Sent: 09 October 2014 16:07
To: Licensing
Subject: Application for Betting Offices Premises Licence - 143 Crockhamwell Road, Woodley

Dear Julia O'Brien

Application for a Betting Office Premises Licence for 143 Crockhamwell Road, Woodley

Although Woodley Town Council has not been consulted on this licensing application and only found out about it two days ago, members of the Community Services Committee have asked me to write notifying you of their opposition to a third betting office in Woodley town centre.

The Town Council and the Woodley Town Centre Management Initiative are aiming to attract a greater diversity of retail units in the town centre, as requested by local residents, and the addition of a third betting office will be counter to this aim. Members are concerned that the addition of a third betting office will have a clustering effect within the confined area of the shopping precinct.

The Committee is also of the opinion that a third betting office will mean that gambling activities will be given a higher profile within the town centre, and children and vulnerable people will be subjected to a greater exposure to these activities. This is likely to lead to an increase in under-age gambling and problem gambling, which in turn will lead to additional problems with crime and disorder.

Yours sincerely

Linda Matthews
Committee Officer
Woodley Town Council
The Oakwood Centre, Headley Road
Woodley, Berkshire, RG5 4JZ
Tel: 0118 9690356

This e-mail is confidential and is intended only for the person(s) named above. If you are not the intended addressee it is requested that you do not copy, distribute or rely on the information contained within the e-mail, as such action may be unlawful. The information, attachments and opinions in this e-mail are those of its author only and do not necessarily represent those of Woodley Town Council.

If it has reached you by mistake then please call 0118 969 0356 to let us know or notify us by e-mail and then delete the message.

Thank you for your help.

Click [here](#) to report this email as spam.

Madeline Ally

3c

From: Mary Holmes <maryirisholmes@talktalk.net>
Sent: 31 October 2014 00:41
To: Licensing
Subject: Re: An application for a 3rd betting /gambling shop in Woodley shopping centre. ~[PROTECT]~

Dear Julia,

As I stated in my email of 9th October, I was commenting as the chairman of Woodley Town Centre Management Initiative.

On the previous evening, we'd held one of our quarterly meetings with Council members, our Town Centre Manager, residents and local traders present and I felt it appropriate to send off my views which also seemed to be in agreement with local people I'd spoken to in the very short time we were given to make any comments.

Kind regards

Woodley Town Cllr Mary Holmes.

----- Original Message -----

From: Licensing
To: 'Mary Holmes'
Sent: Wednesday, October 29, 2014 5:34 PM
Subject: RE: An application for a 3rd betting /gambling shop in Woodley shopping centre. ~[PROTECT]~

Dear Cllr Holmes

As per our Wokingham Gambling Act Statement of Principles Section 5 (page 8) means I need to clarify in what capacity and by whom you have been asked to represent them. Perhaps you could have a look at the appropriate section of the policy I have attached and let me know at your earliest convenience.

Kind Regards

Julia

From: Mary Holmes [<mailto:maryirisholmes@talktalk.net>]
Sent: 09 October 2014 00:00
To: Licensing
Subject: An application for a 3rd betting /gambling shop in Woodley shopping centre.

Dear Sir/Madam,

As the chairman of the Woodley Town Centre Management Initiative which has, over the years, prided itself on trying to oversee a good mix of shops - and choice - within our Town Centre, I am writing to voice my opposition to this application by Coral Racing Ltd for a 3rd betting/gambling outlet within Woodley's shopping centre. The Woodley Town Centre Management Initiative is a body made up of Woodley's traders, Woodley residents and representatives from both Wokingham Borough Council and Woodley Town Council.

The Woodley Town Centre Management Initiative employs an excellent Town Centre Manager who provides us with an increased footfall, year on year, and I think a 3rd similar gambling outlet would absolutely go against the grain. Any new proposed outlet has to be sure of being an asset to Woodley's town centre and I don't think having this 3rd betting shop would, in any shape or form, come up to the mark in this respect!

I honestly think that having a 3rd betting/gambling outlet would be overload and definitely not in the interests of providing a wider range of shopping outlets for the local residents. How can it be realistically possible for three

similar gambling outlets to survive within such a small retail area in today's market place, especially as we're faced with the possibility of having another similar shop just 4 shops away from one already trading there?

Thinking back, I seem to remember that we did at one stage have another betting shop, opposite the Chequers pub in Headley Road, and it indeed folded a few years ago.....presumably due to lack of enough business to make it a viable proposition?

So, please don't go down that route again!

Yours sincerely,

Cllr Mary Holmes - Chairman of Woodley's Town Centre Management Initiative.

Click [here](#) to report this email as spam.

DISCLAIMER

You should be aware that all e-mails received and sent by this Council are subject to the Freedom of Information Act 2000 and therefore may be disclosed to a third party. (The information contained in this message or any of its attachments may be privileged and confidential and intended for the exclusive use of the addressee). The views expressed may not be official policy but the personal views of the originator.

If you are not the addressee any disclosure, reproduction, distribution, other dissemination or use of this communication is strictly prohibited.

If you received this message in error please return it to the originator and confirm that you have deleted all copies of it.

All messages sent by this organisation are checked for viruses using the latest antivirus products. This does not guarantee a virus has not been transmitted. Please therefore ensure that you take your own precautions for the detection and eradication of viruses.

Madeline Ally

From: Jacques Lherbier <tcm@woodley.gov.uk>
Sent: 30 October 2014 15:48
To: Licensing
Cc: 'Mary Holmes'; Keith Baker; Kate Haines; 'Mark Norris'; townclerk@woodley.gov.uk
Subject: RE: NOTIFICATION OF APPLICATION FOR NEW BETTING PREMISES LICENCE - CORAL 143 CROCKHAMWELL ROAD, WOODLEY ~[PROTECT]~

Dear Lisa,

Thank you for your reply.

I did in my capacity of Town Centre Manager working on behalf of the Woodley Town Centre Management Initiative (WTCMI). I had copied my executive sub committee and do once again: Cllr Mary Homes (Chairman), Cllr Keith Baker, Cllr Kate Haines and Mark Norris (Vice-Chair). I also copy the Town Clerk Deborah Mander for information.

The WTCMI (Woodley Town Centre Management Initiative) was established in 1995 and is a partnership between Woodley Town Council, Wokingham Borough Council and the Woodley Traders. The committee is currently Chaired by Mary Holmes and holds four Meetings a year where all Woodley residents & traders are welcome. The WTCMI aims to keep Woodley Shopping Town Centre a successful and enjoyable place to Shop involving the whole Community.

I trust this answers your question but please don't hesitate to contact me if need be.

Best regards

Jacques Lherbier (Town Centre Manager)

Woodley Town Centre Management Initiative (WTCMI)

The Oakwood Centre, Headley Rd Woodley RG5 4JZ

Office: 0118921 6920 Mob: 07506741591

<http://www.woodleytowncentre.co.uk> Follow us on Twitter: @WoodleyTCMI

From: Licensing [mailto:licensing@wokingham.gov.uk]
Sent: 29 October 2014 5:31 PM
To: 'Jacques Lherbier '
Subject: RE: NOTIFICATION OF APPLICATION FOR NEW BETTING PREMISES LICENCE - CORAL 143 CROCKHAMWELL ROAD, WOODLEY ~[PROTECT]~
Importance: High

Dear Jacques

As per our Wokingham Gambling Act Statement of Principles Section 5 (page 8) means I need to clarify in what capacity and by whom you have been asked to represent them. Perhaps you could have a look at the appropriate section of the policy I have attached and let me know at your earliest convenience.

Kind Regards

Julia

From: Jacques Lherbier [mailto:tcm@woodley.gov.uk]
Sent: 09 October 2014 15:08
To: Licensing
Cc: 'Mary Holmes'; Keith Baker; Kate Haines; 'Mark Norris'; townclerk@woodley.gov.uk
Subject: NOTIFICATION OF APPLICATION FOR NEW BETTING PREMISES LICENCE - CORAL 143 CROCKHAMWELL ROAD, WOODLEY ~[PROTECT]~

Dear Julia,

Further to my earlier email (enclosed below). I would also wish to object as Town Centre Manager on the grounds that the Wokingham Borough Council Development Plan in its section covering Retail Policies (Policy TB15) wishes town centre retail units to enhance the vitality and viability of the town centre and there again a third additional Betting Office will achieve neither of these principles.

I copy again the Executive Sub-Committee members of the WTCMI and Deborah Mander, Woodley Council Town Clerk.

Thank you for acknowledging my first objection and I look forward to being informed of the progress in due course

Best regards

Jacques Lherbier (Town Centre Manager)
Woodley Town Centre Management Initiative (WTCMI)
The Oakwood Centre, Headley Rd Woodley RG5 4JZ
Office: 0118921 6920 Mob: 07506741591
<http://www.woodleytowncentre.co.uk> Follow us on Twitter: @WoodleyTCMI

From: Jacques Lherbier [<mailto:tcn@woodley.gov.uk>]
Sent: 09 October 2014 1:48 PM
To: 'licensing@wokingham.gov.uk'
Cc: 'Mary Holmes'; 'keith.baker@wokingham.gov.uk'; 'Kate Haines'; 'Mark Norris'; 'townclerk@woodley.gov.uk'
Subject: FW: - NOTIFICATION OF APPLICATION FOR NEW BETTING PREMISES LICENCE - CORAL 143 CROCKHAMWELL ROAD, WOODLEY ~[PROTECT]~
Importance: High

Dear Julia O'Brien,

Ref: Betting Licence application at 143 Crockhamwell Road. Woodley RG5 3JP

Thank you for your mail received this morning.

The Woodley Town Centre Management Initiative was only made aware of this application two days ago and it was discussed at one of our quarterly Management meetings last night.

We object to the Application on the grounds relating to the Licensing Objectives set out under section 1 of the Gambling Act 2005 (namely a) preventing gambling from being a source of crime or disorder; being associated with crime or disorder; or being used to support crime; b) ensuring that gambling is conducted in a fair and open way, and c) protecting children and other vulnerable persons from being harmed or exploited by gambling).

There are already 2 gambling premises within the Town Centre and a third one would only have a very negative impact, medium to long term to the retail offer of the Centre. It could bring a potential increase in crime and a negative effect on the protection of children (there is a primary school adjacent to the Town Centre), young adults and other vulnerable persons. If a third additional Betting Office is permitted to open, gambling activities will be given a much higher profile and an increased exposure to children and young adults.

I understand Cllr Mary Holmes, Chairman of Woodley's Town Centre Management Initiative has written to you today as well to object and I copy her on this email as well as the Executive Sub-Committee members of the WTCMI and Deborah Mander, Woodley Council Town Clerk.

I would appreciate if you could please acknowledge receipt and keep us informed of the progress.

Best regards

Jacques Lherbier (Town Centre Manager)
Woodley Town Centre Management Initiative (WTCMI)
The Oakwood Centre, Headley Rd Woodley RG5 4JZ
Office: 0118921 6920 Mob: 07506741591
<http://www.woodleytowncentre.co.uk> Follow us on Twitter: @WoodleyTCMI

From: Julia O'Brien [<mailto:Julia.O'Brien@wokingham.gov.uk>] **On Behalf Of** Karen Court
Sent: 09 October 2014 10:46 AM
To: Environmental Health; Development Control; info@gamblingcommission.gov.uk; nru.betting&gaming@hmrc.gsi.gov.uk
Cc: Nicky Jerrome; Shahid Younis; towncentremanager@woodley.gov.uk
Subject: - NOTIFICATION OF APPLICATION FOR NEW BETTING PREMISES LICENCE - CORAL 143 CROCKHAMWELL ROAD, WOODLEY ~[PROTECT]~
Importance: High

GAMBLING ACT 2005
NOTIFICATION OF APPLICATION FOR NEW PREMISES BETTING LICENCE

PREMISES: CORAL, 143 Crockhamwell Road, Woodley, RG5 3JP

The Licensing Team received this application on 11 September 2014

It has been checked and is complete subject to being copied to all responsible authorities in full, as required by the legislation.

Please reply to licensing@wokingham.gov.uk to confirm whether you have received your copy of the application. Representations if any are due by 9th October 2014

If you do not have any comments to make, we would appreciate a "no comments" response from you.

If you have any queries, please let me know.

Regards

Julia O'Brien
Principal Environmental Health Officer
Licensing Service

01635 519849

West Berkshire and Wokingham Environmental Health & Licensing Service

cc: ward councillors & parish / town council - copy of email for information.

DISCLAIMER

You should be aware that all e-mails received and sent by this Council are subject to the Freedom of Information Act 2000 and therefore may be disclosed to a third party. (The information contained in this message or any of its attachments may be privileged and confidential and intended for the exclusive use of the addressee). The views expressed may not be official policy but the personal views of the originator.

If you are not the addressee any disclosure, reproduction, distribution, other dissemination or use of this communication is strictly prohibited.

If you received this message in error please return it to the originator and confirm that you have deleted all copies of it.

All messages sent by this organisation are checked for viruses using the latest antivirus products. This does not guarantee a virus has not been transmitted. Please therefore ensure that you take your own precautions for the detection and eradication of viruses.

Click [here](#) to report this email as spam.

Madeline Ally

From: GREG+TRINIDAD BELLO <greg.bello@btinternet.com>
Sent: 09 October 2014 05:34
To: Licensing
Subject: Objection to a new Betting Shop in Woodley- Mr G Bello

Dear Sir or Madam,

I want to lodge my objection to the application for a new Betting Shop in Woodley Town Centre next to the Post Office under section 161 of the Gambling Act 2005 with Wokingham Borough Council's Licensing Committee (Sub Committee) on the basis that the Licences Objectives under section 1 of the Gambling Act 2005 will be negatively impacted if the application is granted.

I believe that having another betting shop in such a condensed area clustered around the small Woodley Town Centre ; this will bring the number of betting shops in Woodley from 2 to 3 will bring about an increase in crime and anti social behaviour in the small town centre. I am also very concerned about the negative impact this would have on children and young teenagers in our town.

Gambling will have a much higher profile in our small local community and with two betting shops in a small shopping precinct that is more than enough to cater for any adults who wish to place bets on anything.

The other point I would like to make is that we have enough problems of debt and crime and anti social behaviour in our society and having yet another betting shop will only increase this when we are all trying to reduce these problems including Thames Valley Police Service ; Wokingham Borough Council and Her Majesty's Government not to mention the active responsible members of the public who bother to care about the society we and our children live in. This last point may not fit into any criteria for objections but if the Licensing Committee members have children or young teenagers in their families they might care to give a thought to this increase in pressure on them towards gambling, crime and disorder. There are also a lot of families badly affected by debt and gambling with a corrosive effect on their well being .

We should be encouraging other forms of healthy entertainment in our town centres for young people and adults and I ask that this negative application be turned down for the above reasons.

Yours sincerely;

Mr Greg Bello.
Greg Bello
79, Vauxhall Drive
Woodley
Reading
Berkshire
RG5 4EB
0118-9697748 Home
07765-450225 Mobile
E-Mail: greg.bello@btopenworld.com

Madeline Ally

From: Ian Hills <ian.hills@ntlworld.com>
Sent: 09 October 2014 16:09
To: Licensing
Subject: Opposition to new betting shop in Woodley precinct

To whom it may concern.

I am a Woodley resident living at the address given at the end of this email and which is close to Woodley precinct.

I am writing to you to object in the strongest way possible to the opening of yet another betting shop in Woodley precinct. There are already three betting shops in Woodley precinct.

Establishing yet another betting shop will give undue prominence to gambling in an area which is essentially a family community. Children coming out of schools will think that as a result of seeing so many betting shops that is something they should be encouraged to take up when they are older when that is definitely not the case.

It will also encourage both youngsters and adults to take up gambling when the government has already stated it wants to prevent the proliferation of betting shops which would encourage people to gamble.

I would be grateful for a reply to my objection. Thank you.

Ian Hills
3 Halstead Close
Woodley
READING
RG5 4LD

Click [here](#) to report this email as spam.

Madeline Ally

From: Nick Jackson <rev.nickj@gmail.com>
Sent: 29 October 2014 18:38
To: Licensing
Subject: Re: Woodley - Application for a Betting Shop in Crockhamwell Road ~[PROTECT]~

Dear Ms O'Brien

I am making a representation as the Vicar of the Parish of South Lake St James', which extends geographically across the southern half of Woodley, though the precinct itself lies in the Parish of St John's Woodley. As such I have parishioners who live in the neighbourhood and use the Woodley shopping precinct, but feel that I also have a voice on these matters under the category of "business interests" in its wider sense as the representative of a faith group as mentioned in the Gambling Commission's Guidance which is referred to in your document in Section 5 at the bottom of page 8.

Thank you for seeking to clarify my capacity to make a representation in this matter. I hope my comments may contribute to the discussions concerning the Application.

Yours faithfully
Nick Jackson

Rev Nick Jackson
Southlake St James', Woodley
Church Office: 0118 966 2568
T: 0118 969 3445
e: rev.nickj@gmail.com

On 29 October 2014 17:43, Licensing <licensing@wokingham.gov.uk> wrote:

Dear Sir

In respect of our Wokingham Gambling Act statement of principles, attached to this email, could I ask that you look at section 5 page 8 on interested parties and tell me in what capacity you are making a representation in.

Many thanks

Julia O'Brien

From: Nick Jackson [<mailto:rev.nickj@gmail.com>]
Sent: 09 October 2014 17:52
To: Licensing
Subject: Woodley - Application for a Betting Shop in Crockhamwell Road

Dear Sir

It has come to my attention today that there is an application lodged by Corals for a Betting Shop in Crockhamwell Road.

I understand that it is not reasonable to object on the grounds of competition, but with two Betting Shops currently in Woodley precinct, the addition of a third will significantly increase the profile of gambling within the younger members of our community who frequently gather around in the precinct area.

Wokingham Borough is in a position to review whether this application is in the best interests of the residents of Woodley and potential customers of a further Betting Shop in the precinct as it constitutes change of use from an estate agency. I hope that due consideration will be given to the mixed nature of commercial premises currently, and the mix of the community who frequent the shopping centre, including the youth who often congregate in the area. I think it possible that an increase in crime and on-street drinking might ensue.

Thank you for your attention.

Yours faithfully

Nick Jackson

Rev Nick Jackson
Southlake St James', Woodley
Church Office: 0118 966 2568

T: 0118 969 3445
e: rev.nickj@gmail.com

Click [here](#) to report this email as spam.

DISCLAIMER

You should be aware that all e-mails received and sent by this Council are subject to the Freedom of Information Act 2000 and therefore may be disclosed to a third party. (The information contained in this message or any of its attachments may be privileged and confidential and

APPENDIX

3h



A J W BROWN
 44. MAZE DRIVE
 WOODLEY
 BERKS
 RG5 3SA

I object to the Coral application for a shop in the Woodley Precinct.

There are already 2 betting shops in the shopping centre only 100 yards apart.

The new application submitted by Coral is only 3 doors away from Cowanbet and I cannot see how it will enhance the precinct in any way. There are already 8 gaming machines between the existing 2 shops and with the proposed Coral shop it would increase them by another 4 gambling machines which are already a massive problem amongst our society.

I hope you will not grant their application,

Yours faithfully

A handwritten signature in black ink, appearing to read "A J W Brown".

APPENDIX
31

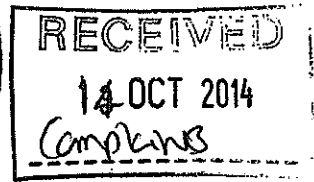

To. Wokingham District Council -

Re:- Bookmaker shops - Woodley Precinct -

I understand there is a proposal for ANOTHER! Bookmakers Shop i.e. Cools, this proposal should be opposed as there are two shops here now, which is quite ~~fit~~ enough for such a small area.

I like to have a bet and find cows better more than ~~advice~~

J. Poulger
34 Wytham Cres -
Woodley
Berks RG5 3AZ.